

# VERTICALE® MultiLocking

VI-5035

[ VI-5035.1; VI-5035.2 ]

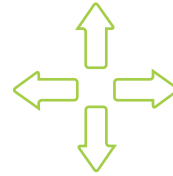

**silony**  
MEDICAL

A)

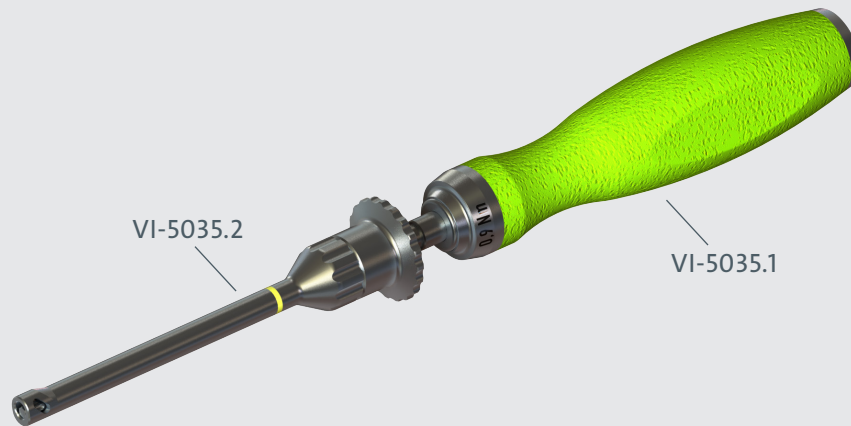

B)

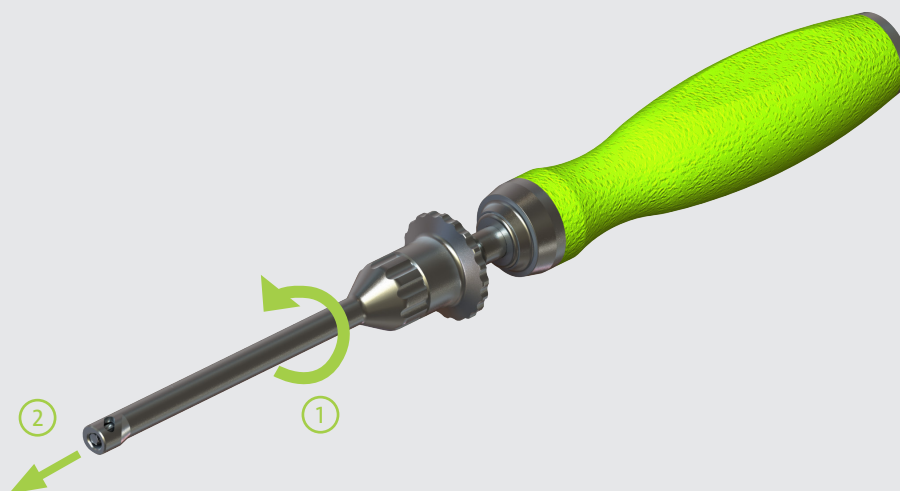

 D30003

1/3

D30226.c.YY  
01.09.2022

 D30204

 **Silony Medical GmbH**

Leinfelder Straße 60  
70771 Leinfelden-Echterdingen

Tel +49 711 78 25 25 0

Fax +49 711 78 25 25 11

[www.silony-medical.com](http://www.silony-medical.com)

 [elabeling.silony-medical.com/contact](mailto:elabeling.silony-medical.com/contact)

MADE IN GERMANY

# VERTICALE® MultiLocking

VI-5035

[ VI-5035.1; VI-5035.2 ]

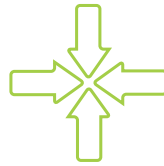

**silony**  
MEDICAL

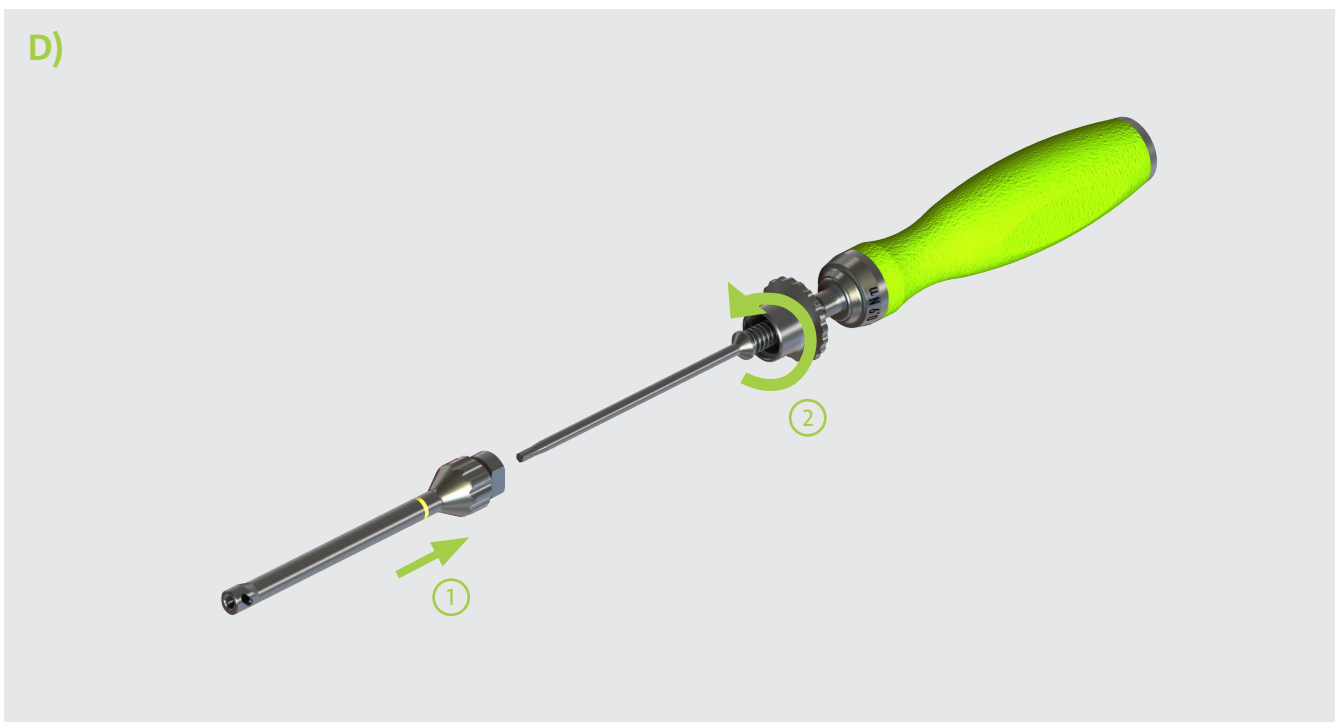

D30003

2/3

D30226.c.YY  
01.09.2022

D30204

**Silony Medical GmbH**

Leinfelder Straße 60  
70771 Leinfelden-Echterdingen

Tel +49 711 78 25 25 0

Fax +49 711 78 25 25 11

[www.silony-medical.com](http://www.silony-medical.com)

[elabeling.silony-medical.com/contact](mailto:elabeling.silony-medical.com/contact)

MADE IN GERMANY

# VERTICALE® MultiLocking

VI-5035

[ VI-5035.1; VI-5035.2 ]

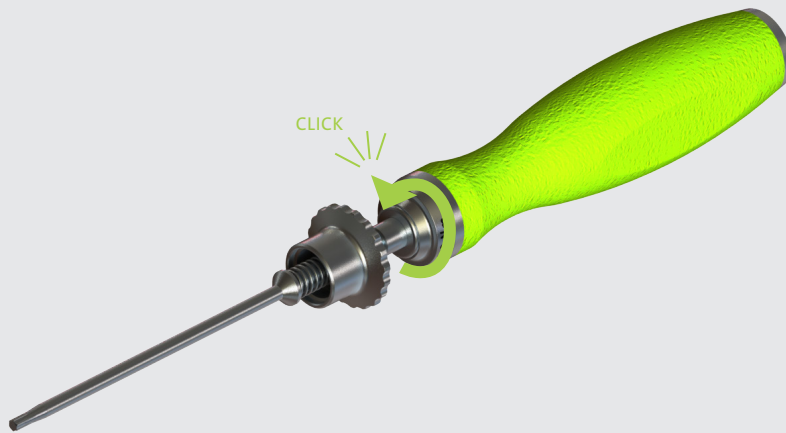

5 x

 D30003

 D30204

3/3

D30226.c.YY  
01.09.2022

 **Silony Medical GmbH**  
Leinfelder Straße 60  
70771 Leinfelden-Echterdingen  
Tel +49 711 78 25 25 0  
Fax +49 711 78 25 25 11  
[www.silony-medical.com](http://www.silony-medical.com)

 [elabeling.silony-medical.com/contact](mailto:elabeling.silony-medical.com/contact)

CE

MADE IN GERMANY